

ONE BARTHOLOMEW, LONDON EC1A 7BL

Farebrother

OFFICE TO RENT | 19,619 SQ FT | POA

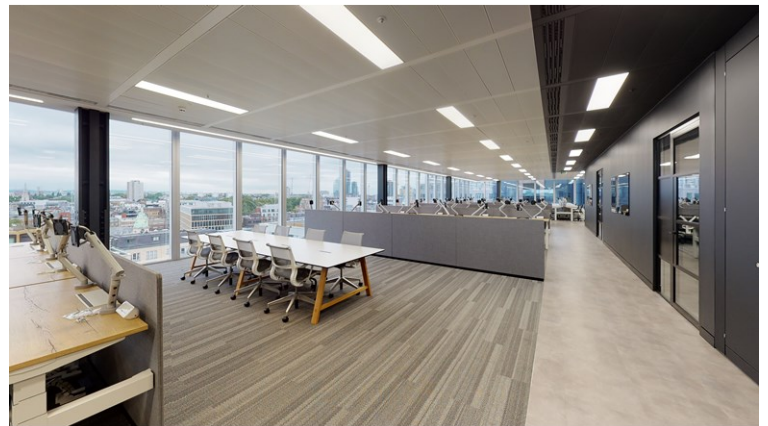
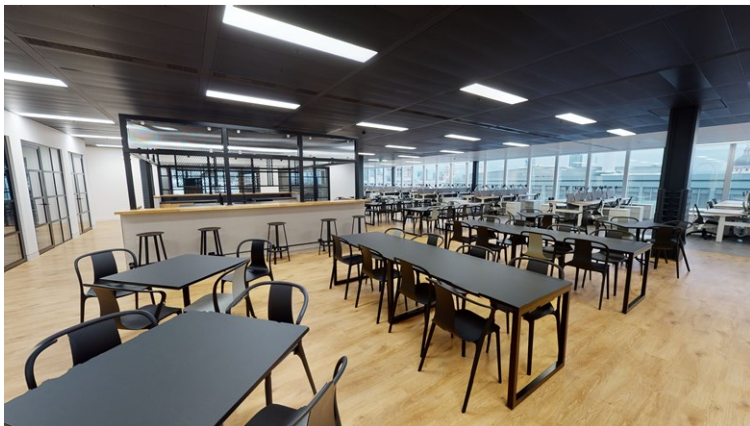

THE REAL ESTATE SPECIALISTS

farebrother.com



FAREBROTHER

5 Chancery Lane,  
London EC4A 1BL

T +44 20 7405 4545

## BEST IN CLASS OFFICE SPACE TO LET

19,619 SQ FT | POA

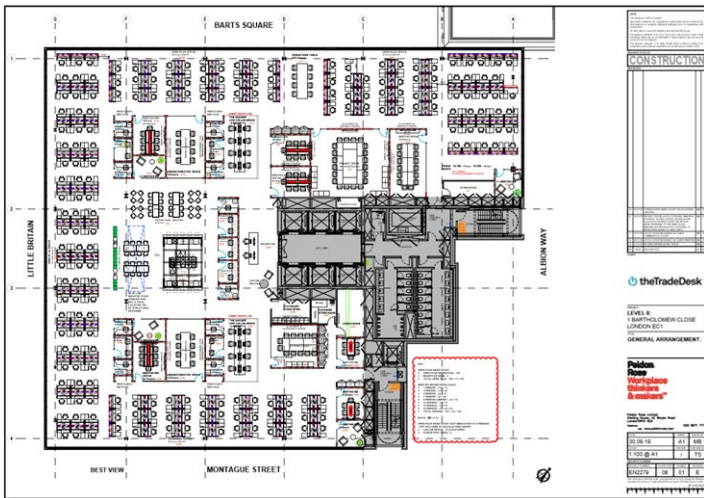

### DESCRIPTION

The 8th floor is available from The Trade Desk and provides 19,619 sq ft of Grade A office space and benefits from a brand new high quality fit out.

The 8th floor is available on flexible lease terms.

The building is situated close to Farringdon station which shall enable quick access to the Elizabeth and Thameslink lines along with the Metropolitan, Circle and Hammersmith & City lines.

### AVAILABILITY

FLOOR	SIZE (SQ FT)	AVAILABILITY
8th Floor	19,619	Available
<b>TOTAL</b>	<b>19,619</b>	

### AMENITIES

- Fully Fitted
- 6 Passenger Lifts
- Occupational density of 1:8 sq m
- Fully accessible raised floor
- 4 pipe fan coil air conditioning
- 2.85m floor to ceiling height
- Bicycle racks
- Shower facilities
- Dedicated independent fibre broadband spine

### TERMS

RENT	RATES	S/C
POA	Est. £24.00 psf	Est £10.00 psf

#### INFORMATION

A new sublease is available for a term by arrangement. Strictly through joint sole agents, Farebrother or Devono Cresa.

B

[Virtual Tour](#)

### GET IN TOUCH

MATTHEW CAUSER	BEN FISHER	BEN ASHBY
Farebrother 020 7855 3530 mcauser@farebrother.com	Farebrother 020 7855 3584 bfisher@farebrother.com	Devono Cresa 020 7451 1331 ba@devonocresa.com